



QUEEN CREEK MARKETPLACE II



PHASE II

SWC POWER RD & CHANDLER HEIGHTS RD | QUEEN CREEK, AZ 85142



PROPERTY HIGHLIGHTS

- » Established shopping center anchored by Basha's/Raley's Market, O'Reilly Auto Parts Store and Ace Hardware
- » Queen Creek Marketplace services a strong residential density - Power Ranch, Seville and Trilogy Communities
- » Demographic is a mixture of young, diverse upper middle-class families

DEMOGRAPHIC HIGHLIGHTS

	1 MILE	3 MILE	5 MILE
2024 Population	7,643	85,743	221,597
2029 Population	8,281	94,031	244,040
2024 Households	2,837	30,125	81,324
2029 Households	3,080	33,044	89,823
Average Household Income	\$91,095	\$111,923	\$98,585
Median Household Income	\$82,101	\$93,929	\$79,570

TRAFFIC COUNTS

	VEHICLES PER DAY
Lake Pleasant Pkwy	21,469
Deer Valley Rd	16,896



W.M. GRACE COMPANIES
SINCE 1966

CONTACT

TOM GRACE
(480) 703-1869
TGRACE@WMGRACECO.COM

JERRY STRAUSS
(602) 418-9164
JSTRAUSS@WMGRACECO.COM



PADS

PAD A

FILIBERTO'S

PAD B - SHOP BUILDING
8,400 SQUARE FOOT
AVAILABLE

PAD C
49,533 SQUARE FOOT
AVAILABLE

SHOPS BUILDING B

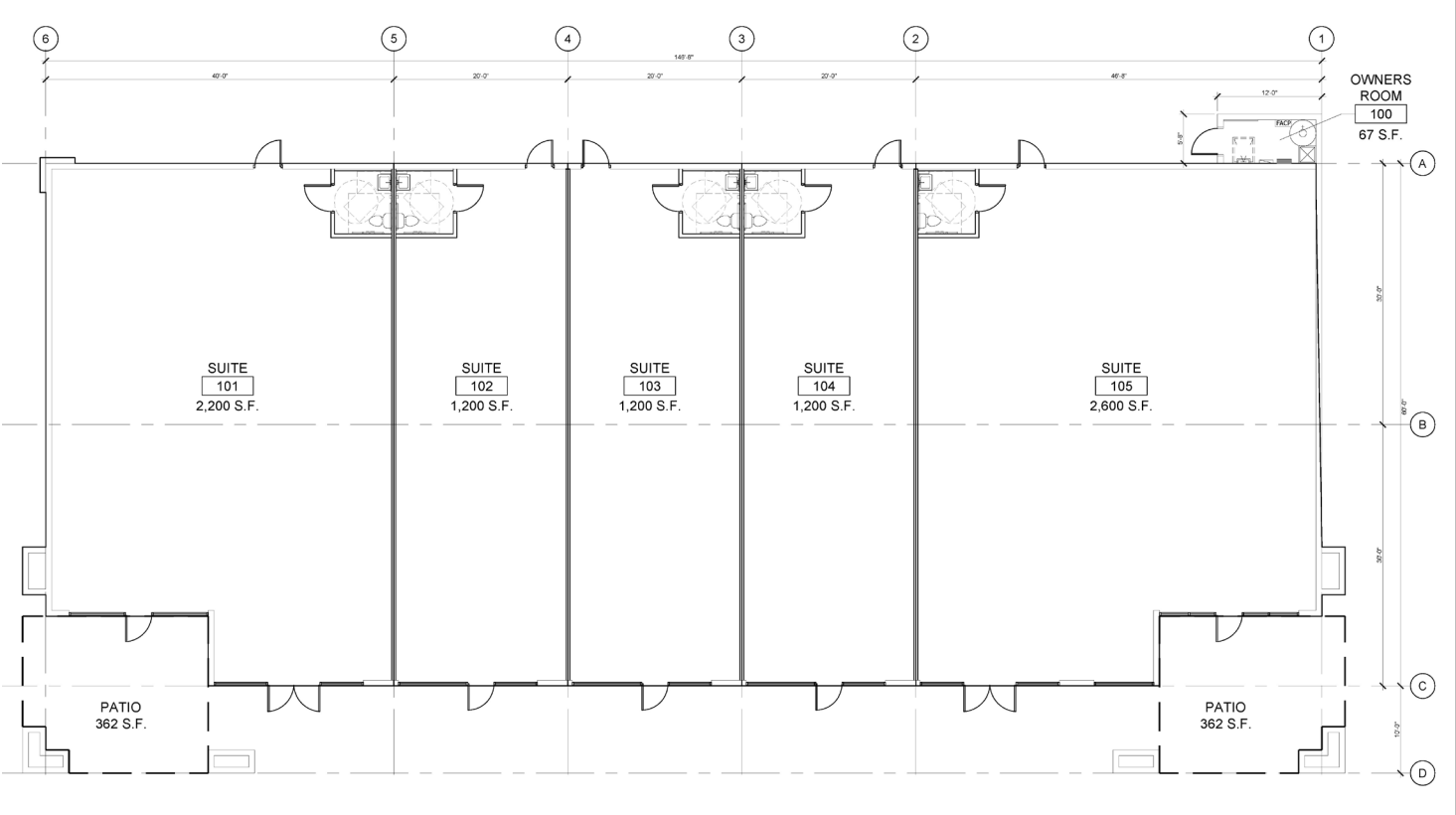

BASIC SUMMARY REPORT

	1 MILE	3 MILE	5 MILE
POPULATION			
2024 Population	7,643	85,743	221,597
2029 Population	8,281	94,031	244,040
HOUSEHOLDS			
2024 Households	2,837	30,125	81,324
2029 Households	3,080	33,044	89,823
Household Size	2.6	2.3	2.3
EMPLOYMENT			
Total Employers	97	885	1,928
Workplace Employees	750	8,820	18,220
RACE			
% White	84.2%	81.1%	79.8%
% Hispanic	17.6%	17.6%	18.4%
% Black	3.0%	4.2%	4.4%
% Asian	3.6%	4.9%	5.3%
% Other	5.4%	5.4%	5.6%
White	2,556	48,045	98,958
Hispanic	533	10,419	22,800
Black	92	2,477	5,461
Asian	108	2,913	6,578
Other	164	3,201	6,913
HOUSING			
% Renter Occupied Housing Units	11.9%	11.9%	16.1%
% Owner Occupied Housing Units	88.1%	88.1%	83.9%
Median Home Value	\$328,443	\$294,363	\$279,714
INCOME			
Average Household Income	\$91,095	\$111,923	\$98,585
Median Household Income	\$82,101	\$93,929	\$79,570
COLLEGE EDUCATION (Age 25+)			
% < 9th Grade	1.8%	1.8%	1.9%
% Some High School	2.8%	2.8%	2.8%
% High School	14.1%	15.3%	16.1%
% Some College	25.4%	27.0%	26.8%
% College-Associates Degree	11%	10.8%	11.3%
% College-Bachelors Degree	30.0%	28.3%	26.9%
% College-Masters Degree	81.3%	80.0%	79.2%
% College-Professional/Doctorate Degree	44.9%	42.2%	41.1%
AGE			
Median Age	37.5	35.6	33.5